

**Licensing Act 2003
Schedule 12
Part A**

Regulation 33,34

Premises Licence

Premises Licence Number

15/02075/LAPRE

Part 1 – Premises Details

Postal address of premises, or if none, ordnance survey map reference or description, including Post Town, Post Code

Watford Football Club
Vicarage Road Stadium
Vicarage Road
Watford
WD18 0ER

Telephone number 01923 496000

Where the licence is time limited the dates

From 7 March 2015

Licensable activities authorised by the licence and the times the licence authorises the carrying out of licensable activities

Sale of alcohol	Monday, Tuesday, Wednesday, Thursday	10:00 - 00:00
	Friday and Saturday	10:00 - 01:00
	Sunday	10:00 - 23:00
	New Year's Eve (if 1 January a Friday or Saturday)	10:00 - 01:00
	New Year's Eve (if 1 January any other day)	10:00 - 00:00
Late Night Refreshment	Monday, Tuesday, Wednesday, Thursday	23:00 - 00:30
	Friday and Saturday	23:00 - 01:30
Exhibition of a Film	Monday, Tuesday, Wednesday, Thursday	10:00 - 00:30
	Friday and Saturday	10:00 - 01:30
	Sunday	10:00 - 23:00
Performance of Live Music	Monday, Tuesday, Wednesday, Thursday	10:00 - 00:30
	Friday and Saturday	10:00 - 01:30
	Sunday	10:00 - 23:00

Performance of Recorded Music	Monday, Tuesday, Wednesday, Thursday Friday and Saturday Sunday	10:00 - 00:30 10:00 - 01:30 10:00 - 23:00
Performance of Dance	Monday, Tuesday, Wednesday, Thursday Friday and Saturday Sunday	10:00 - 00:30 10:00 - 01:30 10:00 - 23:00
Entertainment similar to Music and Dance	Monday, Tuesday, Wednesday, Thursday Friday and Saturday Sunday	10:00 - 00:30 10:00 - 01:30 10:00 - 23:00

The opening hours of the premises

Monday, Tuesday, Wednesday, Thursday	09:00 - 00:30
Friday and Saturday	09:00 - 01:30
Sunday	09:00 - 23:00

Where the licence authorises supplies of alcohol whether these are on and / or off supplies

Alcohol may be sold for consumption on and off the premises.

DRAFT

Part 2

Name, (registered) address, telephone number and email (where relevant) of holder of premises licence

Watford Association Football Club Ltd
Vicarage Road Stadium
Vicarage Road
Watford
WD18 0ER

Registered number of holder, for example company number, charity number (where applicable)

Registered Business Number 104194

Name, address and telephone number of designated premises supervisor where the premises licence authorises for the supply of alcohol

Glyn Evans
[Redacted for this report]

Personal licence number and issuing authority of personal licence held by designated premises supervisor where the premises licence authorises for the supply of alcohol

Personal Licence Number: DAC 031215
Licensing Authority: Dacorum Borough Council

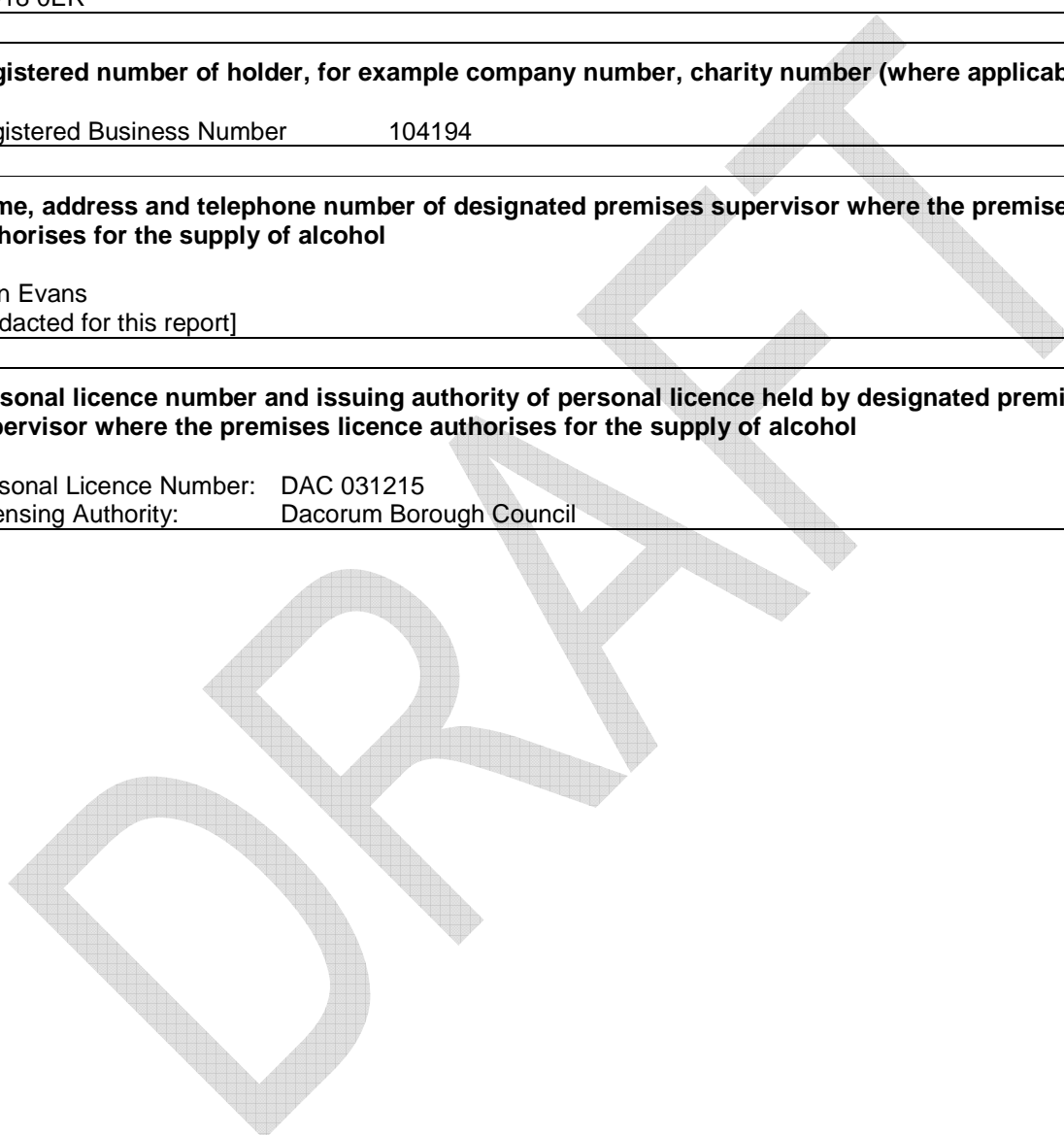

Annex 1 – Mandatory conditions

1. No supply of alcohol may be made under the premises licence –
 - (a) at a time when there is no designated premises supervisor in respect of the premises licence, or
 - (b) at a time when the designated premises supervisor does not hold a personal licence or his personal licence is suspended.
2. Every supply of alcohol under the premises licence must be made or authorised by a person who holds a personal licence.
3. The admission of children under 18 to any film exhibition must be restricted in accordance with any recommendation made by the film classification body specified in section 4, Video Recordings Act 1984 unless the licensing authority notifies the holder of the premises licence that recommendations made by the licensing authority must be followed instead.
4. (1) The responsible person must ensure that staff on relevant premises do not carry out, arrange or participate in any irresponsible promotions in relation to the premises.

(2) In this paragraph, an irresponsible promotion means any one or more of the following activities, or substantially similar activities, carried on for the purpose of encouraging the sale or supply of alcohol for consumption on the premises—
 - (a) games or other activities which require or encourage, or are designed to require or encourage, individuals to—
 - (i) drink a quantity of alcohol within a time limit (other than to drink alcohol sold or supplied on the premises before the cessation of the period in which the responsible person is authorised to sell or supply alcohol), or
 - (ii) drink as much alcohol as possible (whether within a time limit or otherwise);
 - (b) provision of unlimited or unspecified quantities of alcohol free or for a fixed or discounted fee to the public or to a group defined by a particular characteristic in a manner which carries a significant risk of undermining a licensing objective;
 - (c) provision of free or discounted alcohol or any other thing as a prize to encourage or reward the purchase and consumption of alcohol over a period of 24 hours or less in a manner which carries a significant risk of undermining a licensing objective;
 - (d) selling or supplying alcohol in association with promotional posters or flyers on, or in the vicinity of, the premises which can reasonably be considered to condone, encourage or glamorise anti-social behaviour or to refer to the effects of drunkenness in any favourable manner;
 - (e) dispensing alcohol directly by one person into the mouth of another (other than where that other person is unable to drink without assistance by reason of disability).
5. The responsible person must ensure that free potable water is provided on request to customers where it is reasonably available.
6. (1) The premises licence holder or club premises certificate holder must ensure that an age verification policy is adopted in respect of the premises in relation to the sale or supply of alcohol.

(2) The designated premises supervisor in relation to the premises licence must ensure that the supply of alcohol at the premises is carried on in accordance with the age verification policy.

(3) The policy must require individuals who appear to the responsible person to be under 18 years of age (or such older age as may be specified in the policy) to produce on request, before being served alcohol, identification bearing their photograph, date of birth and either—

- (a) a holographic mark, or
- (b) an ultraviolet feature.

7. The responsible person must ensure that—

- (a) where any of the following alcoholic drinks is sold or supplied for consumption on the premises (other than alcoholic drinks sold or supplied having been made up in advance ready for sale or supply in a securely closed container) it is available to customers in the following measures—
 - (i) beer or cider: ½ pint;
 - (ii) gin, rum, vodka or whisky: 25 ml or 35 ml; and
 - (iii) still wine in a glass: 125 ml;
- (b) these measures are displayed in a menu, price list or other printed material which is available to customers on the premises; and
- (c) where a customer does not in relation to a sale of alcohol specify the quantity of alcohol to be sold, the customer is made aware that these measures are available.

8. A relevant person shall ensure that no alcohol is sold or supplied for consumption on or off the premises for a price which is less than the permitted price.

For the purposes of this condition -

- (a) “duty” is to be construed in accordance with the Alcoholic Liquor Duties Act 1979;
- (b) “permitted price” is the price found by applying the formula –

$$P = D + (D \times V)$$

where -

- (i) P is the permitted price,
 - (ii) D is the amount of duty chargeable in relation to the alcohol as if the duty were charged on the date of the sale or supply of the alcohol, and
 - (iii) V is the rate of value added tax chargeable in relation to the alcohol as if the value added tax were charged on the date of the sale or supply of the alcohol;
- (c) “relevant person” means, in relation to premises in respect of which there is in force a premises licence -
 - (i) the holder of the premises licence,
 - (ii) the designated premises supervisor (if any) in respect of such a licence, or
 - (iii) the personal licence holder who makes or authorises a supply of alcohol under such a licence;
 - (d) “relevant person” means, in relation to premises in respect of which there is in force a club premises certificate, any member or officer of the club present on the premises in a capacity which enables the member or officer to prevent the supply in question; and
 - (e) “value added tax” means value added tax charged in accordance with the Value Added Tax Act 1994.

9. Where the permitted price would (apart from this paragraph) not be a whole number of pennies, the price given by that sub-paragraph shall be taken to be the price actually given by that sub-paragraph rounded up to the nearest penny.
10. (1) Sub-paragraph (2) applies where the permitted price on a day (“the first day”) would be different from the permitted price on the next day (“the second day”) as a result of a change to the rate of duty or value added tax.

(2) The permitted price which would apply on the first day applies to sales or supplies of alcohol which take place before the expiry of the period of 14 days beginning on the second day.

DRAFT

Annex 2 – Conditions consistent with the Operating Schedule

The following conditions are considered by officers to be consistent with the Operating Schedule submitted with this application, reference 15/02075/LAPRE:

1. Roving sales persons may sell intoxicating liquor only:
 - (i) in the area at the foot of the banks of seating in the North, East, South and West stands at the stadium, or in the areas of existing outlets on the concourses within the stands;
 - (ii) to persons attending any event with the exception of football matches;
 - (iii) not more than four sales persons may be operating in each stand at any one time;
 - (iv) sales persons must be 18 years of age or over and must receive appropriate training in the sale of alcohol;
 - (v) sales persons must not operate on the stairs or in the gangways and vomitories;
 - (vi) sales persons may only sell beer and lager;
 - (vii) sales persons must deliver alcohol only into the hands of those persons who are purchasing alcohol and not into the hands of any third party.
2. All external handling of glass waste will take place after 0900 hours and before 2300 hours.
3. The premises licence holder shall make available to customers the contact details of local taxi or private hire vehicle firms. Any ordered taxis shall be directed to use the Director's car park to collect customers without sounding their horns.
4. All alcohol shall be supplied in lightweight plastic or similar containers, except that glass containers are permitted within the enclosed hospitality suites. The licence holder shall ensure that no glass containers are permitted within the general public areas.
5. Where Vicarage Road stadium is to be used for an outdoor event which requires a new, or amended, sports ground safety certificate (excluding any certificate relating to the playing of football or rugby), the licence holder shall notify the licensing authority that such an application has been submitted within three working days of submission.
6. Where an outdoor event requires a new, or amended, sports ground safety certificate (excluding any certificates relating to the playing of football or rugby), the licence holder shall provide to the licensing authority a copy of the event management plan which has been agreed by Hertfordshire Fire & Rescue Service and Hertfordshire Constabulary at least 28 days before the proposed event.
7. Where an outdoor event requires a new, or amended, sports ground safety certificate (excluding any certificates relating to the playing of football or rugby), the licence holder shall provide to the licensing authority a copy of the noise management plan which has been agreed by the environmental health authority of Watford Borough Council at least 28 days before the proposed event.

Annex 3 – Conditions attached after a hearing by the licensing authority

There have not been any additional conditions proposed to be attached in response to the representation against this application.

However, this does not restrict the Sub-Committee’s power to attach conditions from the licensing authority’s pool of conditions (amended or otherwise) or to compose their own conditions if they consider that they are appropriate, proportionate, justifiable, and within the applicant’s power to comply with.

DRAFT

Annex 4 – Plans

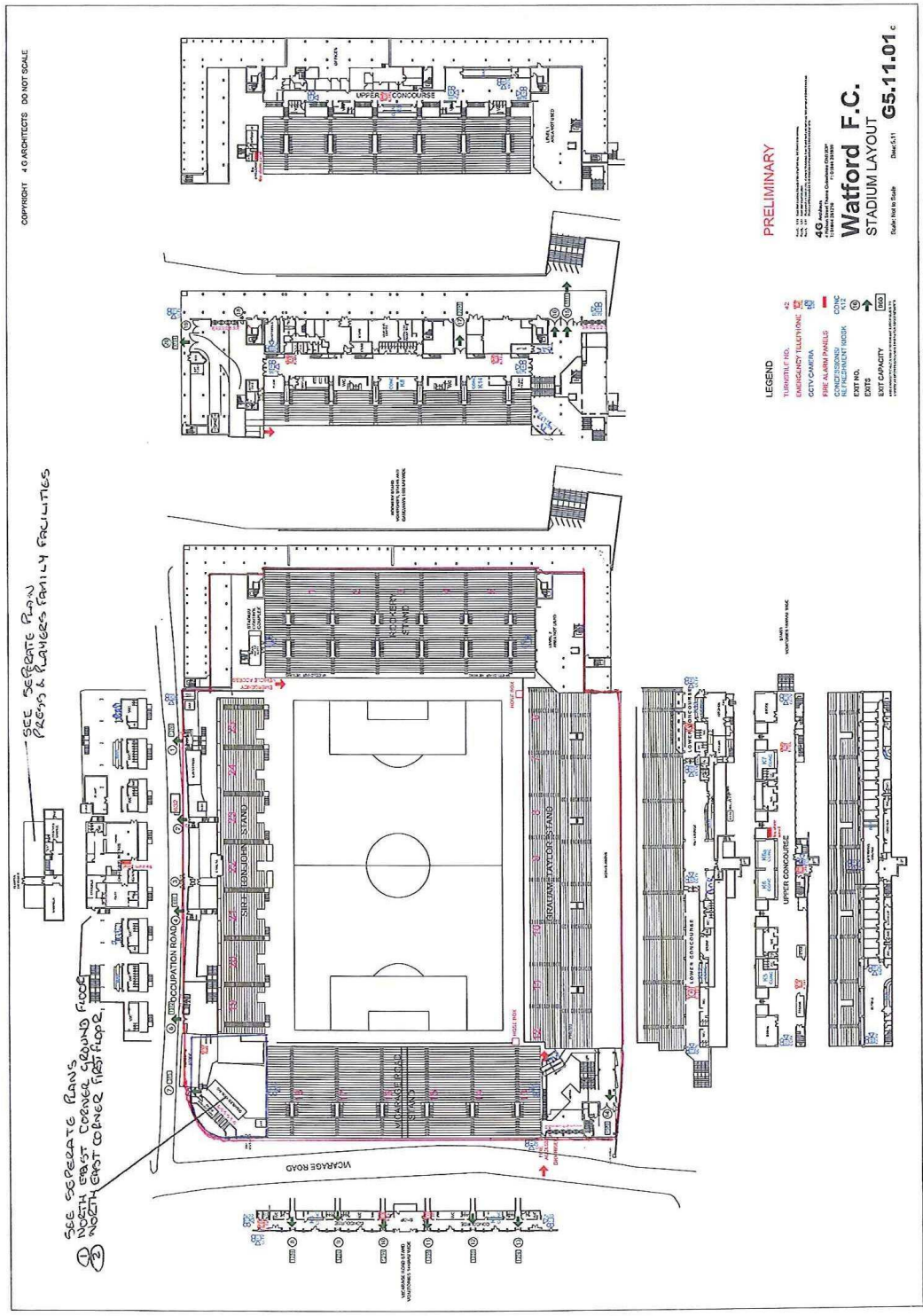

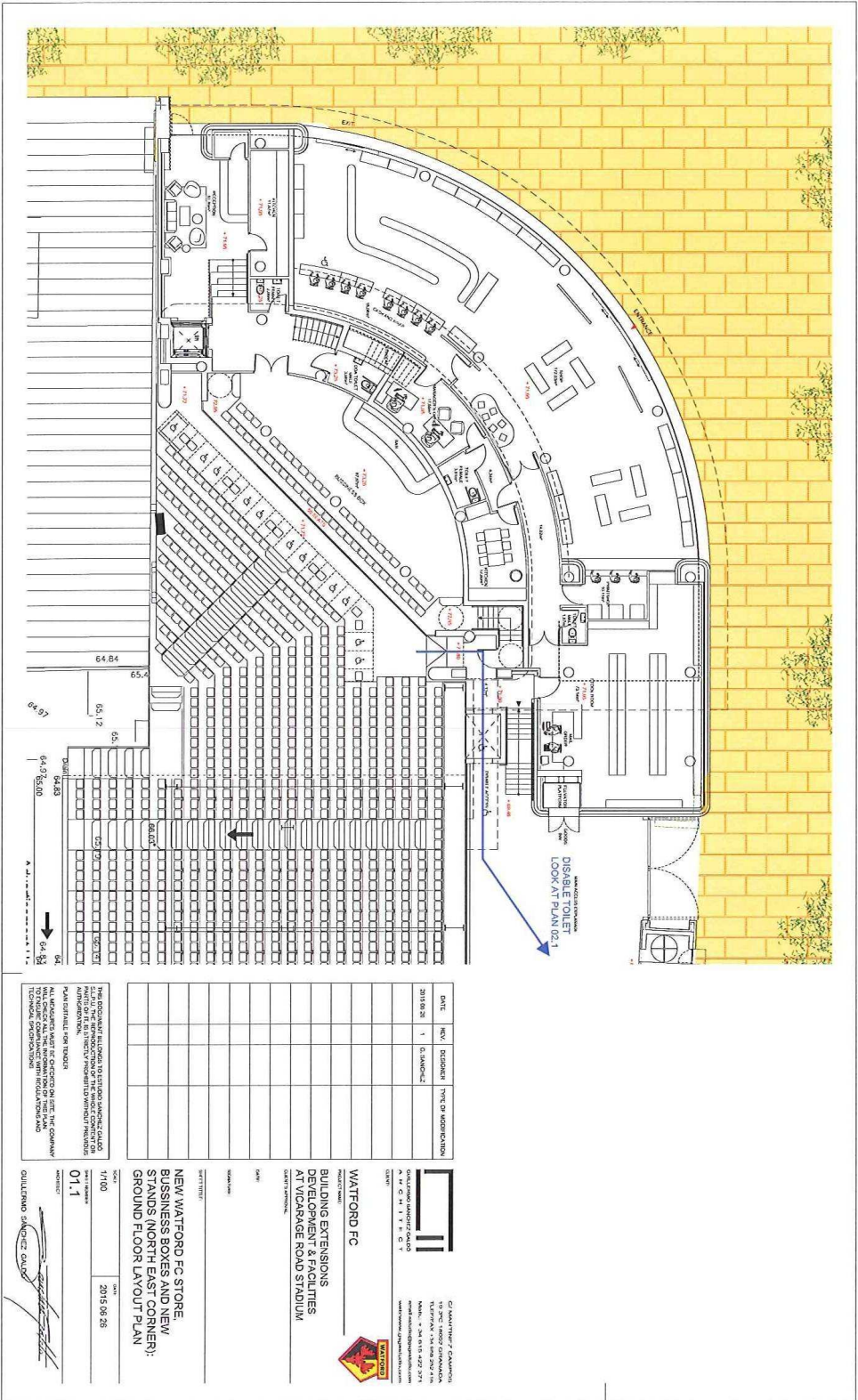

DATE	REV.	REVISION	TYPE OF MODIFICATION
2015 09 29	1	G. SANCHEZ	

WATFORD FC
 BUILDING EXTENSIONS
 DEVELOPMENT & FACILITIES
 AT VIKINGE ROAD STADIUM
 (SEE DRAWINGS)

**NEW WATFORD FC STORE,
 BUSINESS BOXES AND NEW
 STANDS (NORTH EAST CORNER):
 GROUND FLOOR LAYOUT PLAN**

DATE: 28/09/15
 DRAWN BY: G. SANCHEZ
 CHECKED BY: [Signature]
 SCALE: 1/100

ALL DIMENSIONS ARE IN METERS UNLESS OTHERWISE STATED.
 THE DRAWING IS THE PROPERTY OF THE ARCHITECT AND IS NOT TO BE REPRODUCED OR COPIED IN ANY FORM OR BY ANY MEANS WITHOUT THE WRITTEN PERMISSION OF THE ARCHITECT.
 ALL DIMENSIONS ARE IN METERS UNLESS OTHERWISE STATED.
 THE DRAWING IS THE PROPERTY OF THE ARCHITECT AND IS NOT TO BE REPRODUCED OR COPIED IN ANY FORM OR BY ANY MEANS WITHOUT THE WRITTEN PERMISSION OF THE ARCHITECT.

DATE: 28/09/15
 DRAWN BY: G. SANCHEZ
 CHECKED BY: [Signature]
 SCALE: 1/100

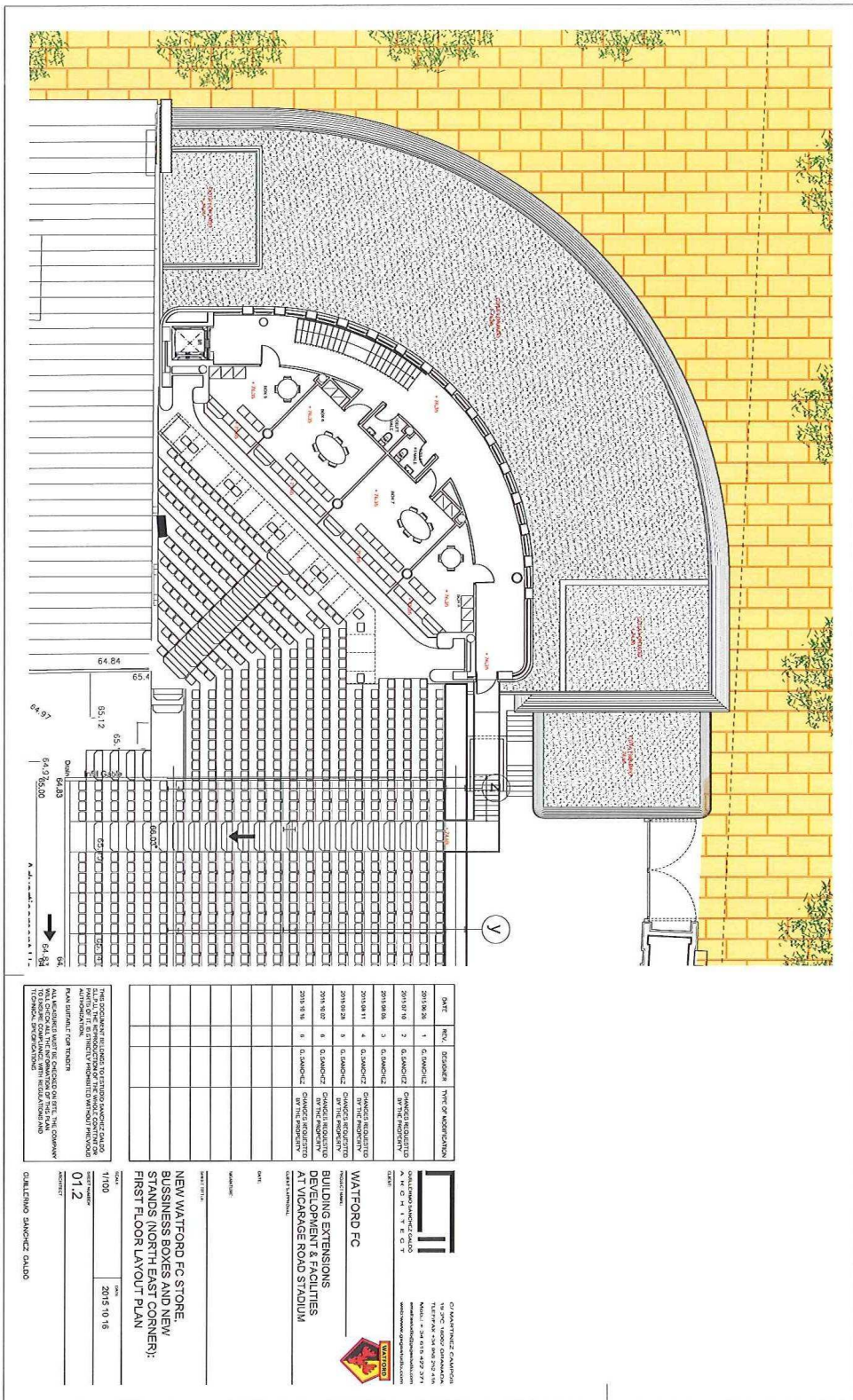

DATE	REVISION	TYPE OF MODIFICATION
2015/06/26	1	05. SANITICIZ
2015/07/02	2	05. SANITICIZ CHANGES INDICATED BY THE ARCHITECT
2015/08/06	3	05. SANITICIZ
2015/08/11	4	05. SANITICIZ BY THE ARCHITECT BY THE ARCHITECT
2015/08/28	5	05. SANITICIZ BY THE ARCHITECT BY THE ARCHITECT
2015/09/02	6	05. SANITICIZ CHANGES INDICATED BY THE ARCHITECT
2015/09/06	8	05. SANITICIZ CHANGES INDICATED BY THE ARCHITECT

WATFORD FC
**BUILDING EXTENSIONS
 DEVELOPMENT & FACILITIES
 AT VICARAGE ROAD STADIUM**
 (SEEY DEVELOPMENT)

DATE: _____
 DRAWN: _____
 CHECKED: _____

NEW WATFORD FC STORE,
 BUSINESS BOXES AND NEW
 STANDS (NORTH EAST CORNER):
 FIRST FLOOR LAYOUT PLAN

DATE: 1/1/08
 SCALE: 2015/10/16

PROJECT NO: 01.2

CLIENT: GUILDFORD SANCORZ GROUP

THIS DOCUMENT IS SUBJECT TO THE STANDARD CONDITIONS OF SALE AND CONTRACT DOCUMENTS WHICH APPLY TO THE DEVELOPMENT. ALL MEASUREMENTS ARE GIVEN AS APPROXIMATE AND SHOULD BE CHECKED ON SITE. THE COMPANY ACCEPTS NO LIABILITY FOR ANY ERRORS OR OMISSIONS. THE COMPANY ACCEPTS NO LIABILITY FOR ANY DAMAGE TO PERSONS OR PROPERTY ARISING FROM THE USE OF THIS DOCUMENT.

